

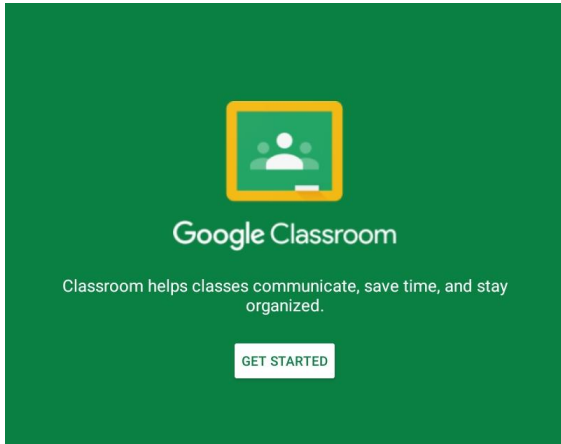

① Click the **Google Classroom** icon located on your home screen. Then click **Get Started**.

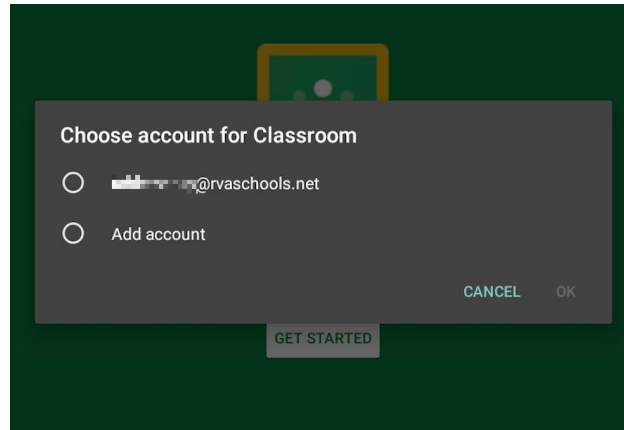

② Choose your RPS account from the list and then click **OK**.



③ Select the role of **Student** if prompted.

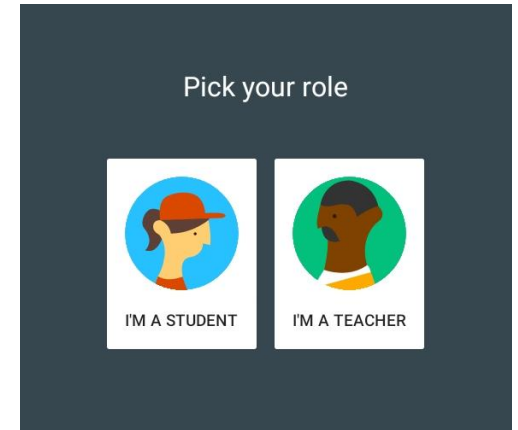

④ A list of your courses will appear once you are logged in. Click **Join** to access your virtual classroom.

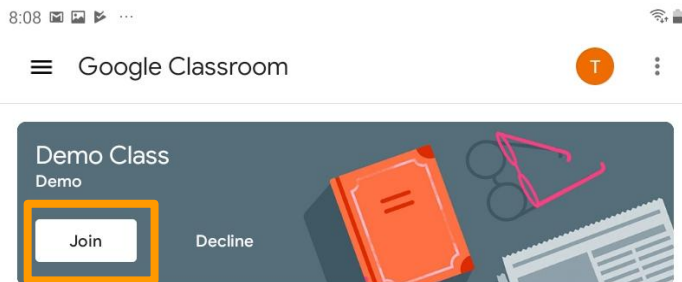

⑤ From the class page, select the **Google Meet** icon (located in the top toolbar) to join the virtual class session.

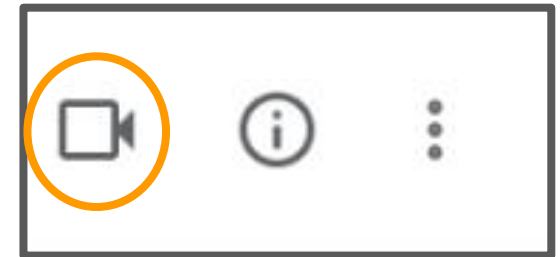
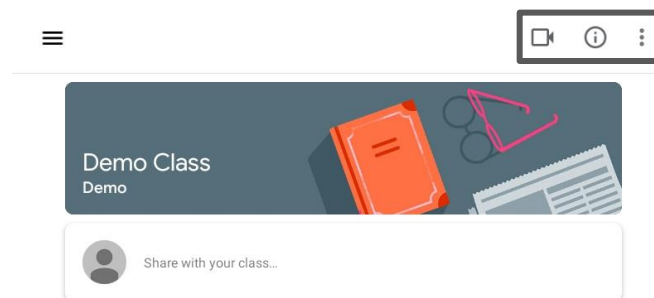

**Google Meet icon**

# Accessing Google Meet From Your RPS Issued Tablet



① From your Google classroom page, select the **Google Meet** icon (located in the top toolbar) to join the virtual class session.

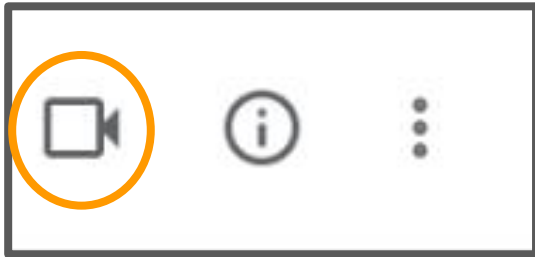

Google Meet icon

② The first time you access Google Meet from your tablet, you will need to allow the microphone and camera to be shared. Click either icon with the red error indicator.



③ Click **Open Settings**.

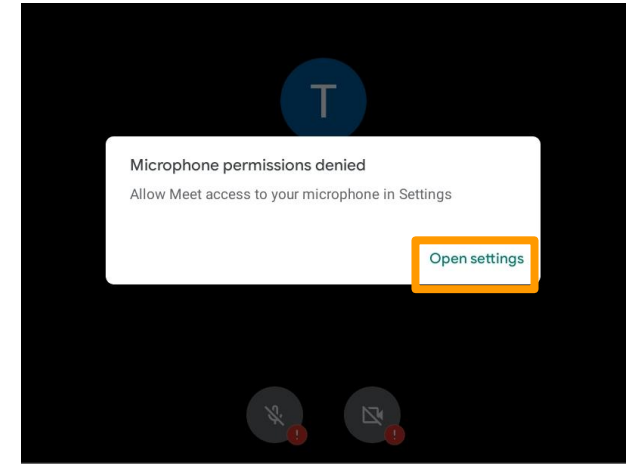

④ From the settings menu, click **Permissions**.

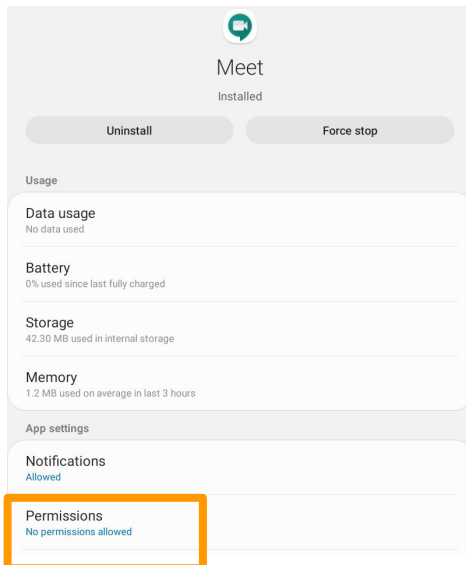

⑤ Ensure the microphone and camera options are turned on.

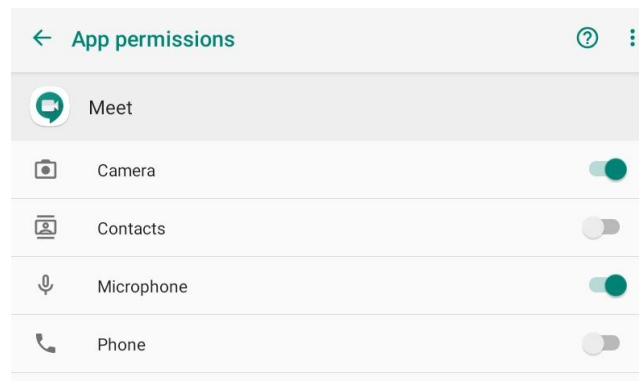

⑥ The error indicators are removed. You will now be able to join your Meet session.

